

生野区  
林寺6丁目

換地確定図

S = 1/500  
X = 4.242  
L = 5.478  
A = 10.714

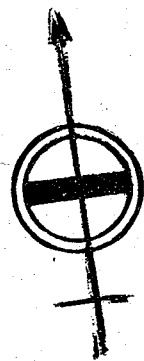

- 8-1 62.71M<sup>2</sup>
- 8-2 50.64M<sup>2</sup>
- 8-3 48.59M<sup>2</sup>
- 8-4 49.28M<sup>2</sup>

- 8-23 61.35M<sup>2</sup>
- 8-22 52.79M<sup>2</sup>
- 8-19 52.03M<sup>2</sup>

X = 4.242  
L = 5.462  
A = 10.677

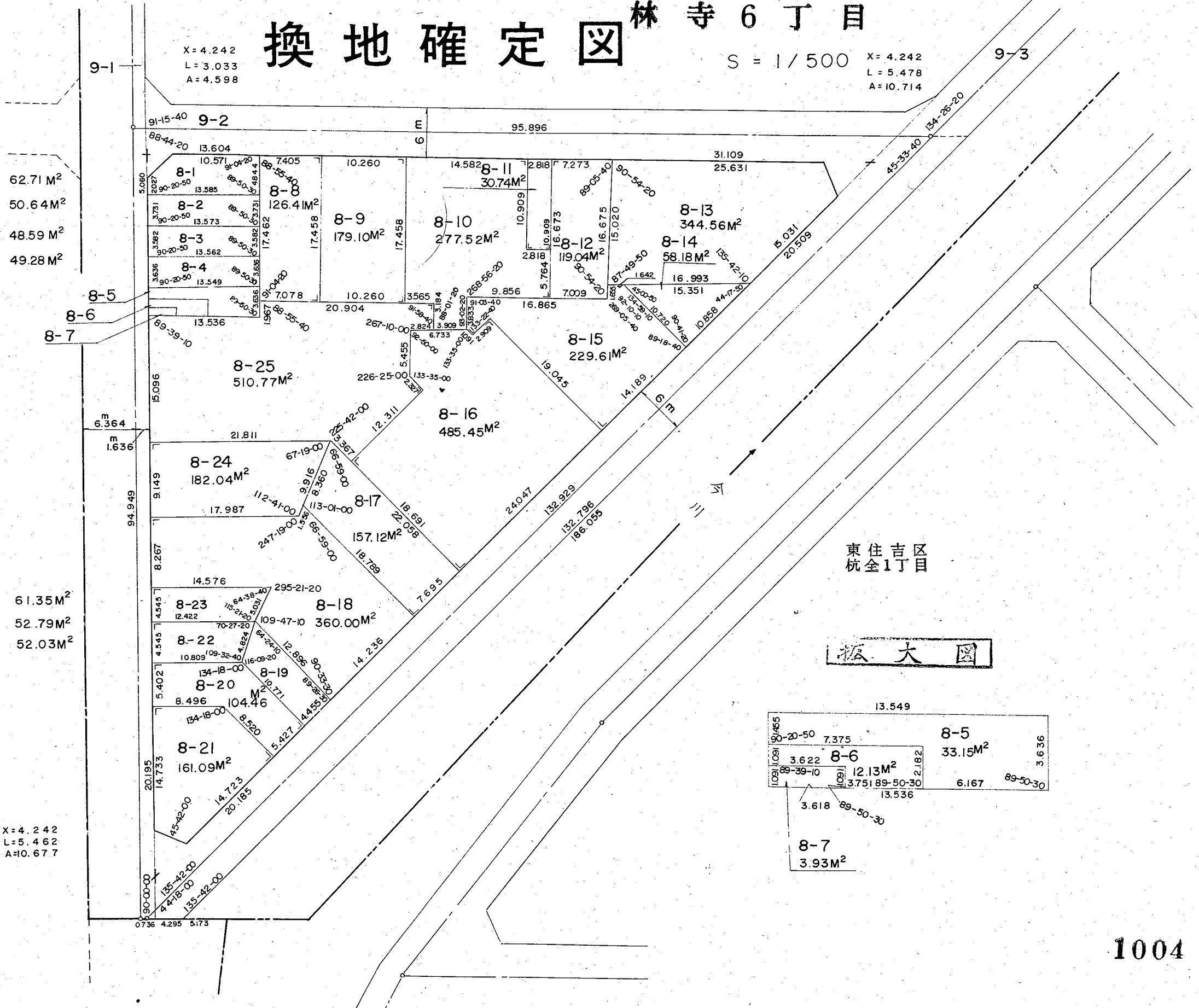

東住吉区  
杭全1丁目  
振大図

