

大阪都市計画豊里土地区画整理事業

確定図

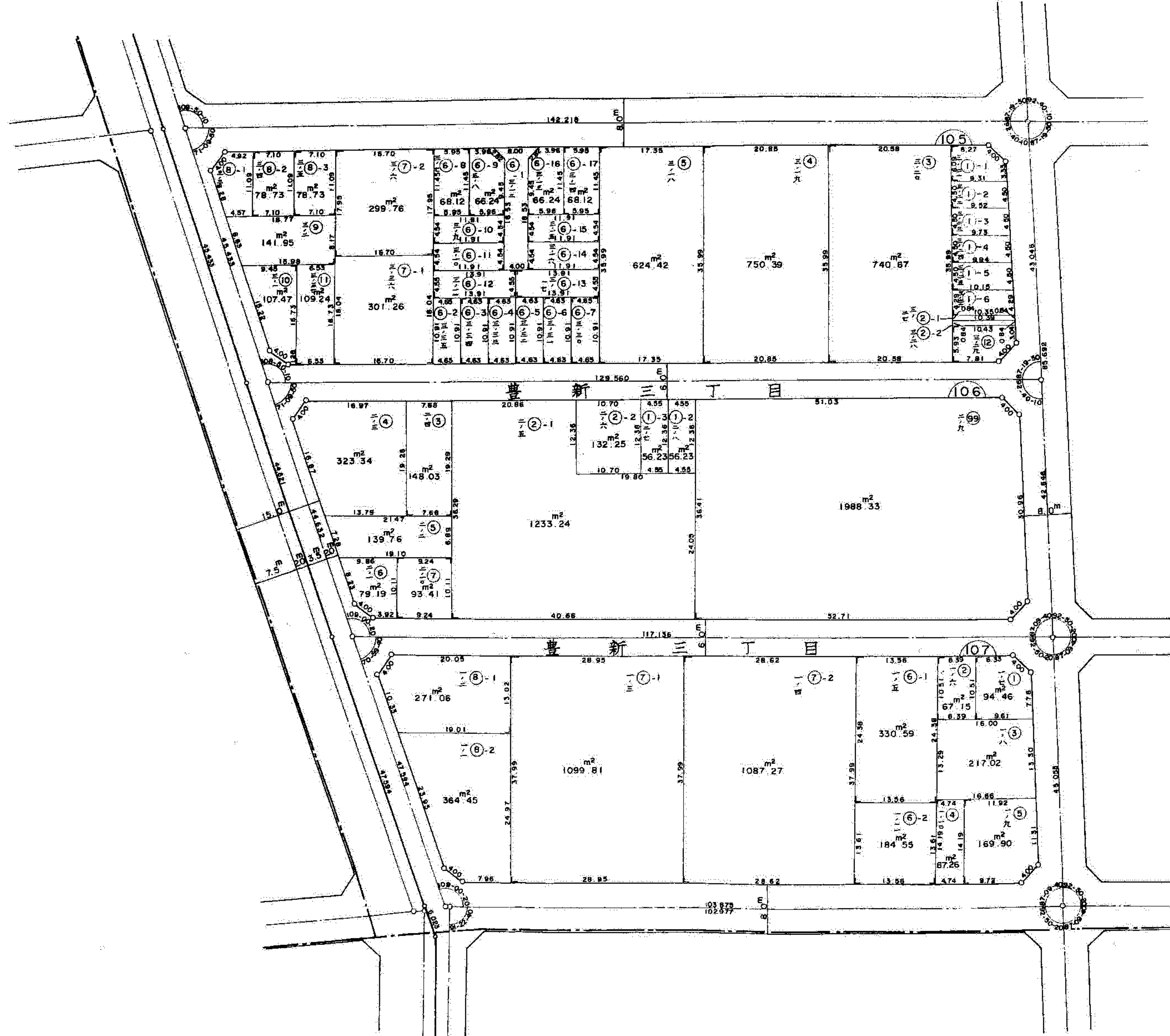
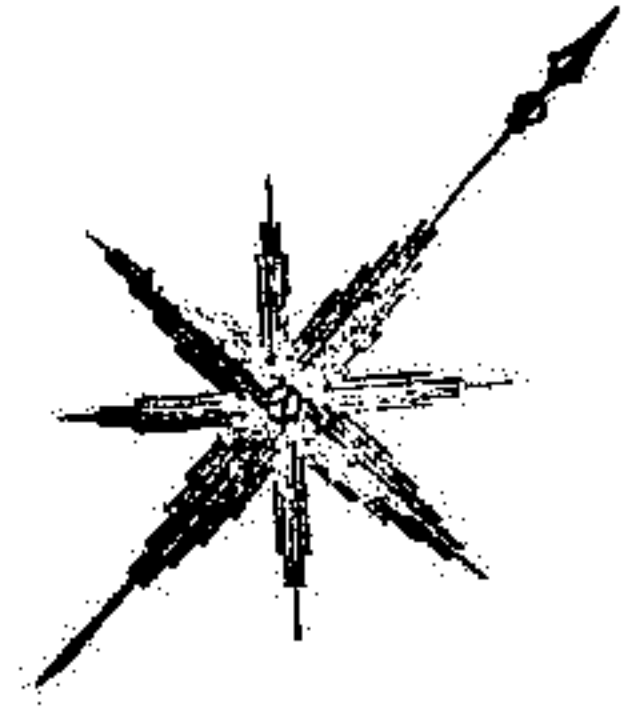

B-105

②-1	6 ^{m²} 7.1	⑥-7	50 ^{m²} 7.3	①-1	52 ^{m²} 0.3
②-2	8 ^{m²} 7.4	⑥-10	54 ^{m²} 0.7	①-2	42 ^{m²} 3.6
⑥-1	86 ^{m²} 1.2	⑥-11	54 ^{m²} 5.7	①-3	43 ^{m²} 3.1
⑥-2	50 ^{m²} 7.3	⑥-12	63 ^{m²} 2.9	①-4	44 ^{m²} 2.5
⑥-3	50 ^{m²} 5.1	⑥-13	63 ^{m²} 2.9	①-5	45 ^{m²} 2.0
⑥-4	50 ^{m²} 5.1	⑥-14	54 ^{m²} 0.7	①-6	43 ^{m²} 9.7
⑥-5	50 ^{m²} 5.1	⑥-15	54 ^{m²} 0.7		
⑥-6	50 ^{m²} 5.1	⑧-1	66 ^{m²} 1.0		
		②	59 ^{m²} 4.9		