

大阪都市計画豊里土地区画整理事業

確定図

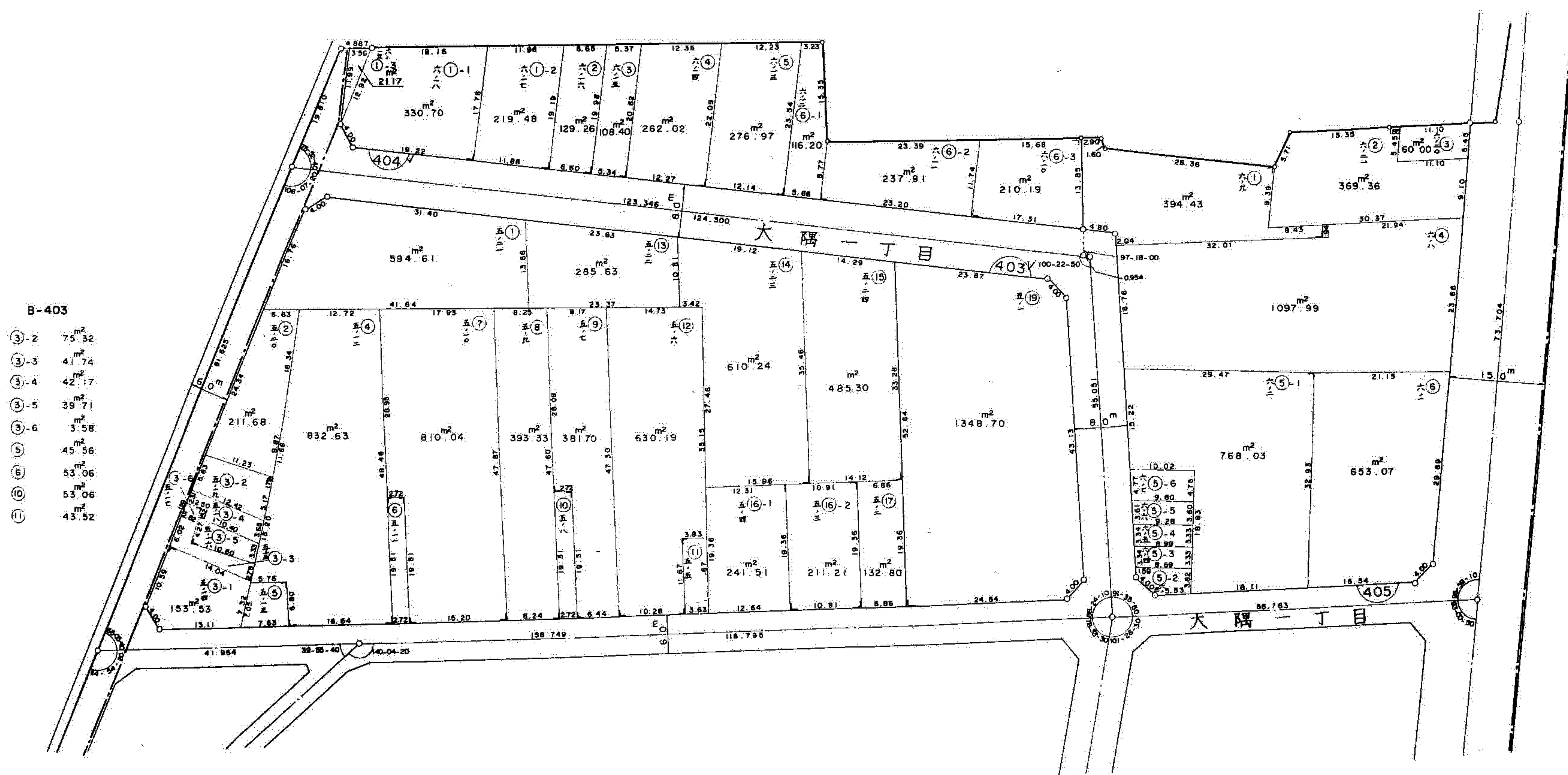
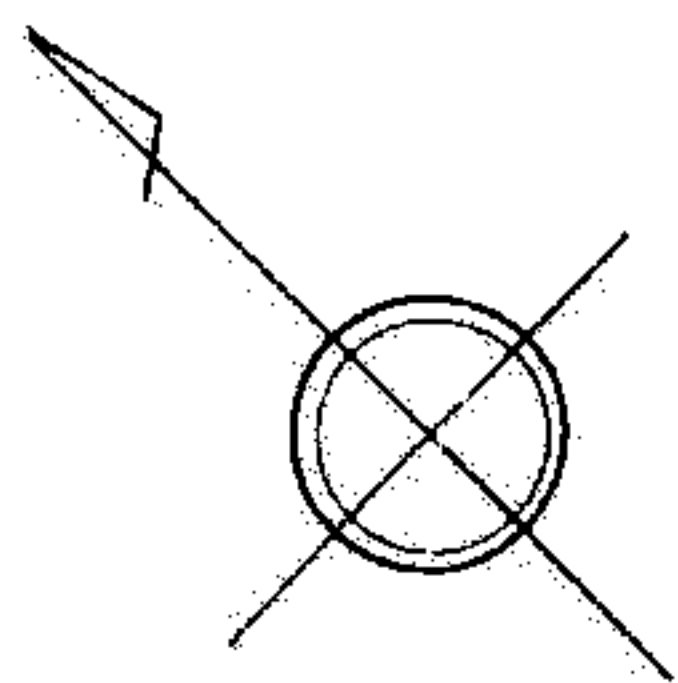

B-403

③-2	75.32 m ²
③-3	41.74 m ²
③-4	42.17 m ²
③-5	39.71 m ²
③-6	3.58 m ²
④	45.56 m ²
⑤	53.06 m ²
⑥	53.06 m ²
⑦	43.52 m ²

B-405

⑤-2	30.91 m ²
⑤-3	29.43 m ²
⑤-4	30.41 m ²
⑤-5	33.98 m ²
⑤-6	46.59 m ²